

EQUAL ANGLES

# 02 | 등변ㄱ형강

EQUAL ANGLES

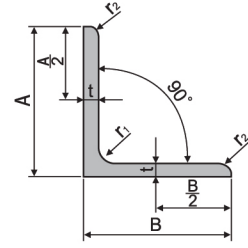

## 2-1 등변ㄱ형강 규격 Specification of Equal Angles

표준단면치수 Standard Sectional Dimension mm				단면적 Sectional Area cm <sup>2</sup>	단위무게 Unit Weight kg/m	중심의 위치 Center of Gravity cm	단면2차모멘트 Moment of inertia cm <sup>4</sup>			단면2차반지름 Radius of Gyration cm			단면계수 Modulus of Section cm <sup>3</sup>
A X B	l	r1	r2				Cx, Cy	Ix,Iy	max,Iu	min,Iv	Ix,Iy	max,Iu	
A 25 X 25	3	4	2	1.427	1.12	0.719	0.797	1.26	0.332	0.747	0.94	0.483	0.448
A 30 X 30	3	4	2	1.727	1.36	0.844	1.42	2.26	0.59	0.908	1.14	0.585	0.661
A 40 X 40	3	4.5	2	2.336	1.83	1.09	3.53	5.6	1.46	1.23	1.55	0.79	1.21
A 40 X 40	4	4.5	3	3.046	2.39	1.12	4.46	7.09	1.84	1.21	1.53	0.78	1.55
A 40 X 40	5	4.5	3	3.755	2.95	1.17	5.42	8.59	2.25	1.2	1.51	0.774	1.91
A 50 X 50	4	6.5	3	3.892	3.06	1.37	9.06	14.4	3.76	1.53	1.92	0.983	2.48
A 50 X 50	6	6.5	4.5	5.644	4.43	1.44	12.6	20	5.23	1.5	1.88	0.963	3.55
A 65 X 65	6	8.5	4	7.527	5.91	1.81	29.4	46.6	12.2	1.98	2.49	1.27	6.26
A 65 X 65	8	8.5	6	9.761	7.66	1.88	36.8	58.3	15.3	1.94	2.44	1.25	7.96
A 75 X 75	6	8.5	4	8.727	6.85	2.06	46.1	73.2	19	2.3	2.9	1.48	8.47
A 75 X 75	9	8.5	6	12.69	9.96	2.17	64.4	102	26.7	2.25	2.84	1.45	12.1
A 75 X 75	12	8.5	6	16.56	13.0	2.29	81.9	129	34.5	2.22	2.79	1.44	15.7
A 90 X 90	7	10	5	12.22	9.59	2.46	93	148	38.3	2.76	3.48	1.77	14.2
A 90 X 90	10	10	7	17.00	13.3	2.57	125	199	51.7	2.71	3.42	1.74	19.5
A 90 X 90	13	10	7	21.71	17.0	2.69	156	248	65.3	2.68	3.38	1.73	24.8
A 100 X 100	7	10	5	13.62	10.7	2.71	129	205	53.2	3.08	3.88	1.98	17.7
A 100 X 100	10	10	7	19.00	14.9	2.82	175	278	72	3.04	3.83	1.95	24.4
A 100 X 100	13	10	7	24.31	19.1	2.94	220	348	91.1	3	3.78	1.94	31.1
A 130 X 130	9	12	6	22.74	17.9	3.53	366	583	150	4.01	5.06	2.57	38.7
A 130 X 130	12	12	8.5	29.76	23.4	3.64	467	743	192	3.96	5	2.54	49.9
A 130 X 130	15	12	8.5	36.75	28.8	3.76	568	902	234	3.93	4.95	2.53	61.5
A 150 X 150	12	14	7	34.77	27.3	4.14	740	1180	304	4.61	5.82	2.96	68.1
A 150 X 150	15	14	10	42.74	33.6	4.24	888	1410	365	4.56	5.75	2.92	82.6
A 150 X 150	19	14	10	5.38	41.9	4.4	1090	1730	451	4.52	5.69	2.91	103

# 02 | 등변ㄱ형강

EQUAL ANGLES

**2-2 등변ㄱ형강 포장표 Packing Table of Equal Angles**

규격 Specification		포장테이블 Packing Table								
치수 Dimension mm	단위무게 Unit Weight kg/m	kg/BD	길이 / Length							
			5m	6m	7m	8m	9m	10m	11m	12m
A 25 X 25 X 3	1.12	총본수	-	223	-	223	178	177	162	148
		총중량	-	1,499	-	1,998	1,794	1,982	1,994	1,989
A 30 X 30 X 3	1.36	총본수	-	184	-	184	163	147	133	122
		총중량	-	1,501	-	2,002	1,995	1,99	1,990	1,991
A 40 X 40 X 3	1.83	총본수	110	182	156	133	121	110	99	91
		총중량	1,006	1,998	1,998	1,947	1,993	2,013	1,993	1,998
A40 X 40 X 4	2.39	총본수	81	138	119	104	93	81	76	70
		총중량	868	1,979	1,991	1,988	2,00	1,936	1,998	2,008
A40 X 40 X 5	2.95	총본수	67	113	96	84	75	67	61	56
		총중량	988	2,000	1,982	1,982	1,991	1,977	1,979	1,962
A45 X 45 X 4	2.74	총본수	-	120	105	90	79	72	64	60
		총중량	-	1,973	2,014	1,973	1,948	1,973	1,929	1,973
A50 X 50 X 4	3.06	총본수	66	108	93	81	72	66	59	54
		총중량	1,010	1,983	1,992	1,983	1,983	2,020	1,986	1,983
A50 X 50 X 6	4.43	총본수	45	75	64	56	50	45	41	37
		총중량	997	1,994	1,985	1,985	1,994	1,994	1,998	1,967
A55 X 55 X 4	3.37	총본수	60	-	-	-	-	60	-	-
		총중량	1,011	-	-	-	-	2,022	-	-
A 65 X 65 X 6	5.91	총본수	33	56	48	42	38	33	30	28
		총중량	975	1,966	1,986	1,986	2,021	1,950	1,950	1,986
A 65 X 65 X 8	7.66	총본수	26	45	35	35	30	25	25	20
		총중량	996	2,068	1,877	2,145	2,068	1,992	2,107	1,838
A 75 X 75 X 6	6.85	총본수	30	48	42	38	32	30	27	24
		총중량	1,028	1,973	2,014	2,082	1,973	2,055	2,034	1,973
A 75 X 75 X 9	9.96	총본수	22	32	30	24	22	22	19	16
		총중량	1,096	1,912	2,092	1,912	1,972	2,191	2,082	1,912
A 75 X 75 X12	13.0	총본수	16	27	22	19	16	16	14	14
		총중량	1,040	2,106	2,002	1,976	1,872	2,080	2,002	2,184

# 02 | 등변 7형강

EQUAL ANGLES

2-3 등변 7형강 포장표 Packing Table of Equal Angles

규격 Specification		포장테이블 Packing Table							
치수 Dimension mm	단위무게 Unit Weight kg/m	pcs/BD	길이 / Length						
		kg/BD	6m	7m	8m	9m	10m	11m	12m
A 90 X 7	9.59	총본수	35	30	25	24	21	20	17
		총중량	2,014	2,014	1,918	2,071	2,014	2,110	1,956
A 90 X 9	12.1	총본수	28	23	20	19	15	15	13
		총중량	2,033	1,948	1,936	2,069	1,815	1,997	2,075
A 90 X 10	13.3	총본수	25	22	20	17	15	14	12
		총중량	1,95	2,048	2,218	2,035	1,995	2,048	1,915
A 90 X 13	17.0	총본수	20	17	15	14	12	10	10
		총중량	2,040	2,023	2,040	2,142	2,040	1,870	2,040
A 100 X 7	10.7	총본수	30	27	24	20	20	17	15
		총중량	1,967	2,022	2,054	1,926	2,140	2,001	1,926
A 100 X 10	14.9	총본수	22	20	17	15	14	12	12
		총중량	1,967	2,086	2,026	2,012	2,086	1,967	2,146
A 100 X 13	19.1	총본수	18	18	15	12	12	12	9
		총중량	1,948	2,006	2,139	2,063	1,910	2,101	2,063
A 130 X 9	17.9	총본수	18	18	15	1012	12	12	9
		총중량	1,933	2,225	2,148	1,933	2,148	2,363	1,933
A 130 X 12	2..4	총본수	15	12	12	9	9	9	9
		총중량	2106	1966	2246	1895	2,106	2,317	2,527
A 130 X 15	28.8	총본수	12	12	9	9	9	6	6
		총중량	2,074	2,419	2,074	2,333	2,592	1,901	2,074
A 150 X 12	27.3	총본수	12	10	9	9	9	6	6
		총중량	1,966	1,911	1,966	2,211	2,457	1,802	1,966
A 150 X 15	33.6	총본수	10	9	9	6	6	6	5
		총중량	2,016	2,117	2419	1,814	2,016	2,218	2,016
A 150 X 19	41.9	총본수	9	9	6	6	5	5	5
		총중량	2,263	2,2640	2,011	2,263	2,095	2,305	2,514